

SMART EMBEDDED DISPLAY - 7.0-INCH IPS TFT LCD 800*480 WITH CAPACITIVE TOUCH - ETEMB070027XDRAL

Features:

- 15:9 7-inch 800*480 resolution IPS TFT display module
- 262K colors
- Brightness: 800 nits with capacitive touch screen
- Industrial Interface: FD CAN , RS485, USB(TYPE C)
- 7-36VDC Power supply range.
- Super Wide View: 80/80/80/80(L/R/U/D)
- The capacitive touch panel can be flexibly customized with features such as water rejection, glove support, etc.
- Arm M33 based MCU, and flash (up to 128 MB)

[Print](#)

Software

RTOS, GUI Development Software, and Initialization tool

FreeRTOS, TouchGFX, and CubeMX

Board Support Package

TouchGFX's tpa file support
Bootloader and flash-loader files

IDE

GCC, CubeIDE, IAR, and MDK-ARM

Overall

Size

7.0 inch

Outline Dimensions

188(W) x 127.04(H) x 19.3(D)(max) mm

Bonding Technology	Air Bonding
Display	
Color	262K
Panel Type	IPS-TFT LCD, Transmissive, Normally Black
Viewing Angle	Super Wide View, 80/80/80/80 (L/R/U/D)
Active Area (A.A.)	152.4(W) x 91.44(H) mm
Resolution	800RGB x 480
Brightness	800 nits
Viewing Area	153.2(W) x 92.24(H) mm
Active Area	152.4(W) x 91.44(H) mm
Dot Size	0.0635(W) x 0.1905(H) mm
Pixel Size	0.1905(W) x 0.1905(H) mm
Touch	
Type	Capacitive Touch Panel (CTP)
IC:	MICROCHIP mXT640UD
Structure	2 mm chemically strengthened cover glass
Power Consumption	
Voltage	7~36 V
	7 V: 910 mA
Current	12 V: 540 mA
	36 V: 185 mA
PoE Voltage	N/A
PoE Current	N/A
Embedded	
MCU	STM32U599
Internal SRAM	2.5MB
External SDRAM	N/A
Internal Flash	2MB
External Flash	32MB
Interface	
Power over Ethernet	N/A
USB	TYPE C
CAN	CAN 2.0 and FD CAN
UART	RS485
SPI	N/A
I2C	N/A
GPIO	N/A
Programming	SWD interface (ST-link)

Environment

Operating Temperature

-20~70 °C

Storage Temperature

-30~80 °C

Vibration

Operating: N/A

Storage: 11.76 m/s² (1.2g)

Shock

Operating: N/A

Storage: 490 m/s² (50g)

Certification

CE Certification

YES

ETEMB070027XDRAL | 800(RGB) x 480

DIMENSIONS

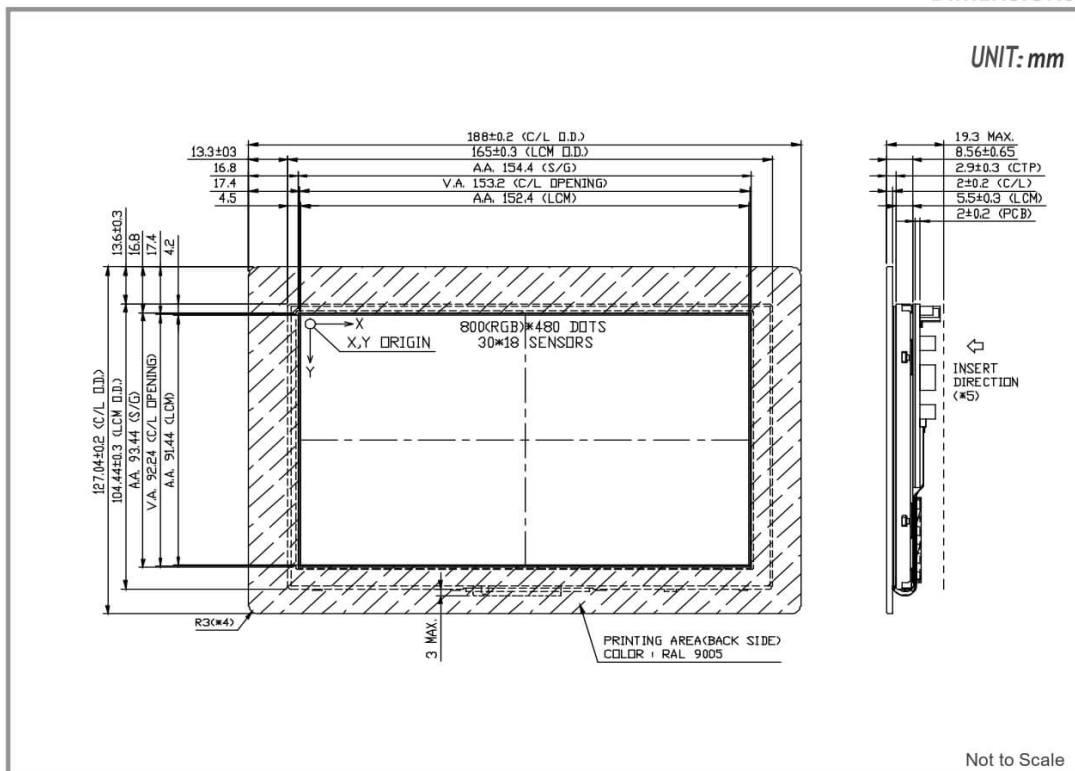

www.edtc.com

Emerging Display Technologies Corp.

Copyright 2007

Browser not compatible.